

A PROJECT BY

HELIOS INFRA

Helios Infra is a well established company of Surat. The company that delivers what it promises to do. With a rich history and background of building some of the important landmarks in Surat, **Helios Infra** is all set to develop some luxurious and lavish residence. With numbers of years of experience, the founders are known for their impeccable structures, sharp business acumen, inclination to preservation of natural resources, and providing the best of amenities along with reasonable pricing, with a concept based planning.



With the splendid host of amenities that La- Helios has, your time at home will always be marvelous. There is a space for everyone...

LA-HELIOS

PREMIUM ROW-HOUSE WITH AMPLE SPACE TO LIVE

MODERN FACILITIES

- Elegant Main Entrance Gate with Security Cabin & Compound wall with Textured Plaster
- Well Designed C.O.P Considering Celebrating Indian Festival
- Clubhouse with integrated Gymnasium
- Landscape Garden with Senior Citizen Sitting & Children Play Area
- Multipurpose Game Court
- Amphi-Theatre
- Jogging Track
- CCTV Surveillance Covered in all Common Areas (Main Gate, Internal Roads, C.O.P.)
- Internal Roads with Premium Pavers or R.C.C.
- S.M.C. Sweet Water Connection in all Units



ENTRANCE GATE



LANDSCAPED GARDEN



SITTING AREA



CHILDREN PLAY AREA



AMPHI THEATRE



JOGGING TRACK



SECURITY



GYM



La-HELIOS

PREMIUM ROW-HOUSE WITH AMPLE SPACE TO LIVE

*There are very few things that are bought but never sold, they are treasured.
At La Helios, it's a legacy you rightly earn.*

*Designed to perfection, the ambience outside and the vastness inside is a class apart.
True luxury with comfort living is at its best.*



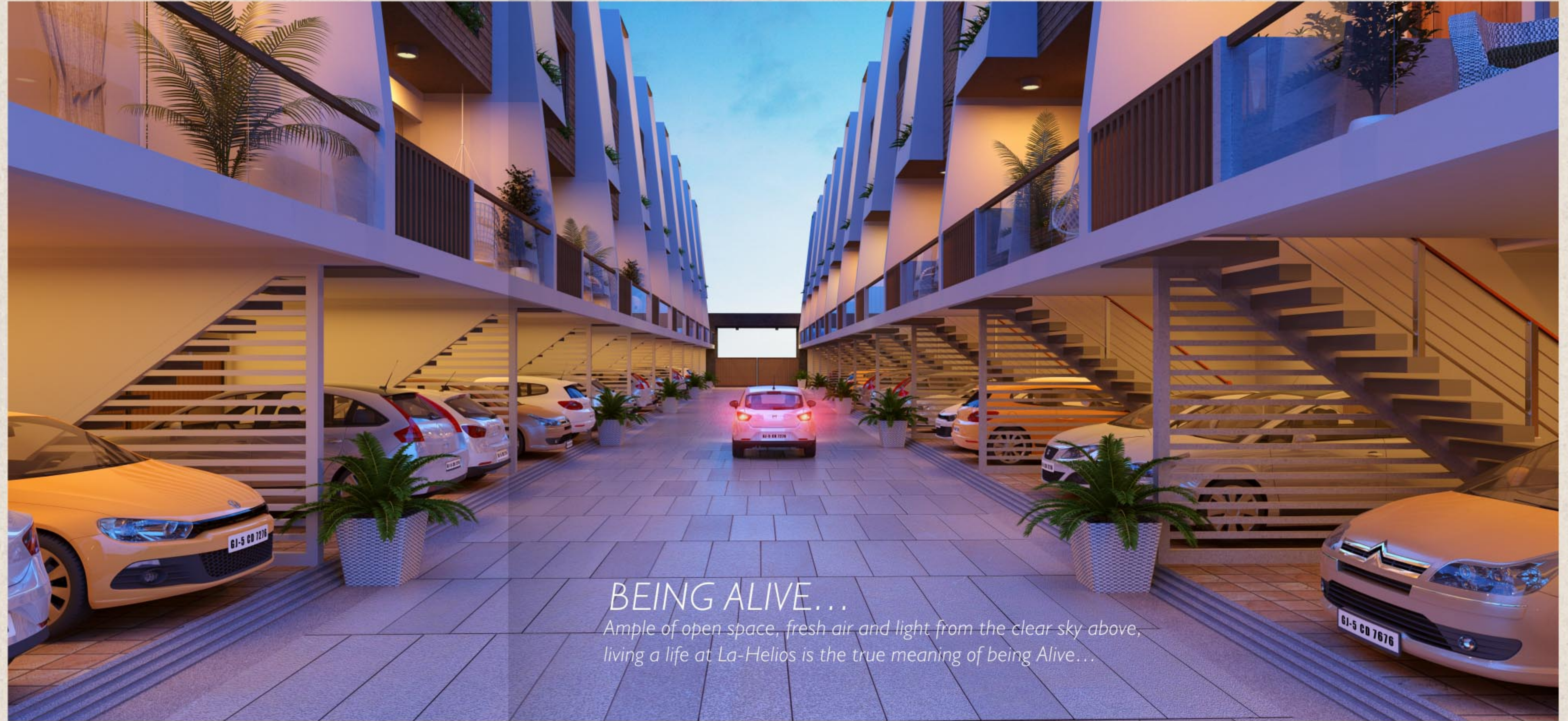

BEING ALIVE...

Ample of open space, fresh air and light from the clear sky above,
living a life at La-Helios is the true meaning of being Alive...



HAPPINESS

Enjoy evening, Challenge your neighbour for a game of tennis, have a nice time with your family at the Amphi Theater, Burn your calories in the Gym... you bet...it's all about happiness.



LA-HELIOS
PREMIUM ROW-HOUSE WITH AMPLE SPACE TO LIVE

LAYOUT PLAN

Perfect architecture for the Perfect people...



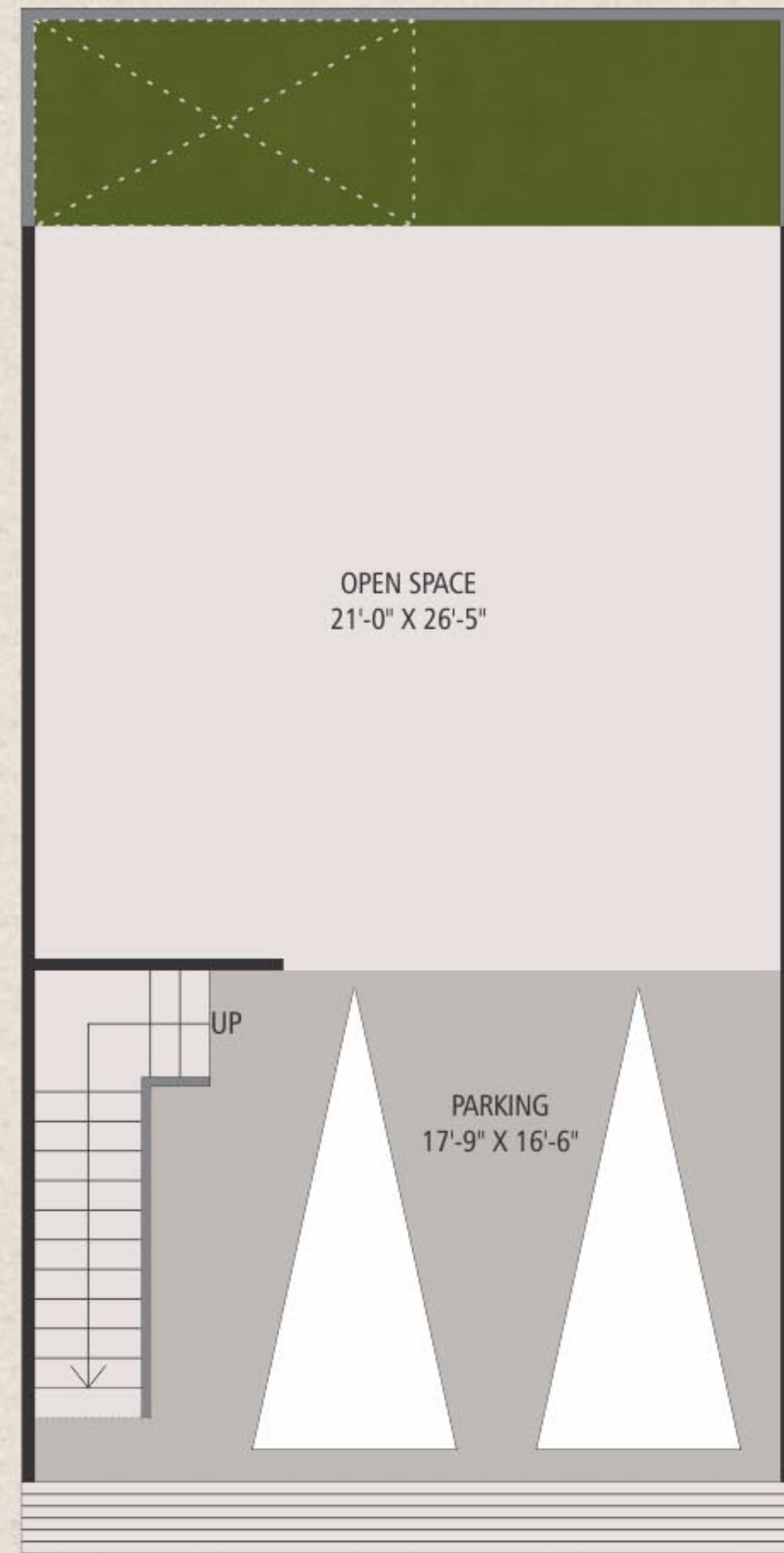

GROUND
FLOOR PLAN
FLOOR HT.-9'-6"



HIGHER GROUND
FLOOR PLAN
FLOOR HT.-10'-0"



FIRST
FLOOR PLAN
FLOOR HT.-10'-0"



SECOND
FLOOR PLAN
FLOOR HT.-10'-0"





OWNERS PLOT



MULTIPURPOSE COURT



GYM

MODERN FACILITIES

La-HELIOS

PREMIUM ROW-HOUSE WITH AMPLE SPACE TO LIVE

*From lush green surroundings,
to spacious rooms and splendid amenities,
La-Helios is the ideal place to live your dream life.*



GARDEN

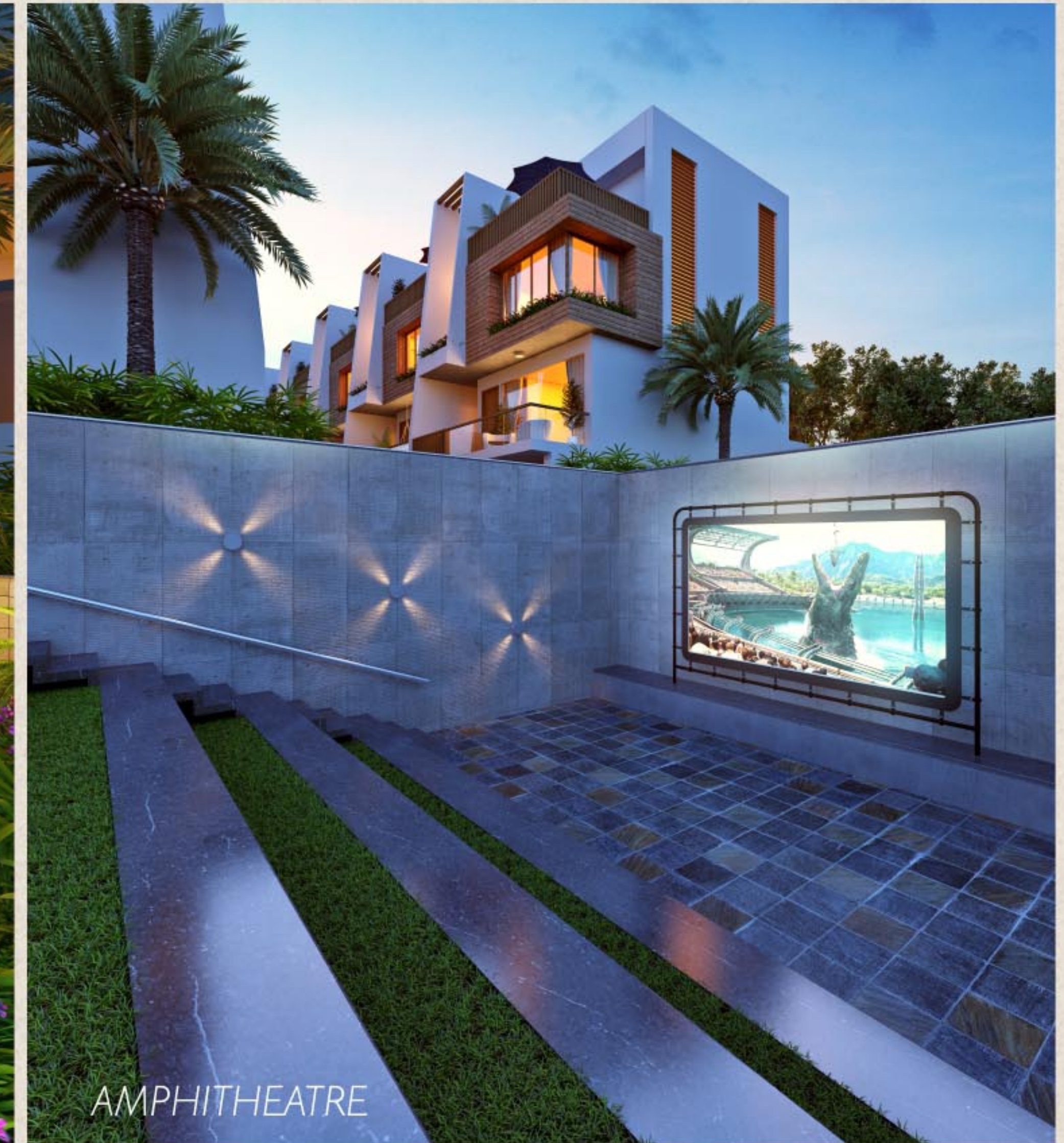

AMPHITHEATRE

LA-HELIOS

PREMIUM ROW-HOUSE WITH AMPLE SPACE TO LIVE

UNIT STRUCTURE

Framed RCC building as per IS 456 (concrete) & IS 1893 (seismic)

UNIT SPECIFICATION

PARKING

- 3 Cars Private Parking
- M.S. Fabricated Gate. (Inner Phase)
- Polished Kota Flooring
- U.G. Water tank

LIVING ROOM

- Main Door of Teak Wood Frame and Premium Shutter with Night Latch of Standard Make
- Balcony - River Washed Granite Flooring
- 32" x 48" Premium Vitrified Tiles Flooring
- Granite Staircase with S.S. Railing

KITCHEN & DINING

- Granite Top with ISI Sink
- 32" x 48" Premium Vitrified Tiles Flooring
- Dedo (Vitrified Tiles up to Lintel Level)
- Guj. Gas Connection

WASH AREA

- Kota Flooring
- Extra Space for Washing Machine & Dishwasher

BEDROOMS

- Wooden Flooring in One Master Bedroom
- 24" x 24" Premium Vitrified Tiles Flooring
- Doors with Granite Frame and Flush Type Shutter
- Windows with Granite Sill and Premium Aluminum Section with Sliding and Safety Grill
- Premium Vitrified Tiles Flooring in Balcony with Glass Railing

TOILETS

- Granite Door Frame with Waterproof Shutter
- Well Designed Bathroom with Premium Fittings (Jaguar or Equivalent)
- Open Plumbing for easy Maintainance

FLOOR HEIGHT

- 9.6" Parking
- 10.0" All Floor

TERRACE

- Waterproofing with China Mosaic Flooring
- O.H. Water Tank

ELECTRIFICATION

- Individual 3 Phase Meters
- A.C. Points In all Bedrooms & Living Room
- Cables of Standard Make (Polycab or Equivalent)

INTERNAL WALL FINISHED

- Single Coat Mala Plaster with Birla Putty

EXTERNAL UNIT FINISHES

- Textured Plaster in Front Side
- Double Coat Mala Plaster in Back Side
- ICI- Weather shield max color

LOCATION MAP

- CABLE STAYED BRIDGE IS ABOUT 2.50 KM.
- NEW PROPOSED UMRA-PAL BRIDGE ROAD CONNECT PROJECT
- MAIN R.T.O. OFFICE IS ABOUT 2.00 KM.
- SANJEEV KUMAR AUDITORIUM IS ABOUT 2.00 KM.
- CENTRALLY LOCATED BETWEEN PREMIUM RESIDENTIAL & COMMERCIAL COMPLEXES.

